

**THE A46 TRUNK ROAD (NEWARK TO  
WIDMERPOOL IMPROVEMENT AND SLIP  
ROADS) SUPPLEMENTARY  
COMPULSORY PURCHASE ORDER  
NUMBER 1  
20\_\_**





DEPARTMENT FOR TRANSPORT

HIGHWAYS ACT 1980

ACQUISITION OF LAND ACT 1981

THE A46 TRUNK ROAD (NEWARK TO WIDMERPOOL IMPROVEMENT  
AND SLIP ROADS) SUPPLEMENTARY COMPULSORY PURCHASE  
ORDER NUMBER 1 20\_\_

COMPULSORY PURCHASE OF LAND AND NEW RIGHTS IN  
THE PARISH OF FARNDON, IN THE DISTRICT OF NEWARK AND  
SHERWOOD IN THE COUNTY OF NOTTINGHAMSHIRE

Notice is hereby given that the Secretary of State for Transport has prepared in draft the A46 Trunk Road (Newark to Widmerpool Improvement and Slip Roads) Supplementary Compulsory Purchase Order Number 1 20\_\_ under sections 239, 240 and 246 of the Highways Act 1980, and under section 2 of the Acquisition of Land Act 1981. He is about to make this Order, and if made, the Order will authorise the Secretary of State for Transport to purchase compulsorily the land and the new rights described below for the purpose of:

- a) the construction of the new trunk road in The Parish of Farndon, in the District of Newark and Sherwood in the County of Nottinghamshire;
- b) the construction and improvement of highways and the provision of new means of access to premises in the parish and district in pursuance of the A46 Trunk Road (Newark To Widmerpool



Improvement and Slip Roads) Supplementary (Side Roads)  
Order Number 1 20\_\_;

- c) the improvement of the Trunk Road in the parish and district;
- d) the diversion of watercourses and the execution of other works on watercourses in connection with the construction of the new trunk road and the construction and improvement of other highways;
- e) use by the Secretary of State for Transport in connection with such construction and improvement of highways and the execution of other works mentioned above;

Copies of the draft Order and of the map referred to therein have been deposited and may be seen at all reasonable hours from 12<sup>th</sup> May 2011 at the offices of the Highways Agency, The Cube, 199 Wharfside Street Birmingham B1 1RN; and at Nottinghamshire County Council, Trent Bridge House, Fox Road, West Bridgford, Nottingham, NG2 6BJ; and at Newark & Sherwood District Council, Kelham Hall, Kelham, Newark, NG23 5QX; and at Newark Library, Beaumont Gardens, Balderton Gate, Newark, NG24 1UW; and at Bingham Library, Eaton Place, Bingham, NG12 5FF.

Any objection to the draft compulsory purchase order must be made in writing and addressed to the Secretary of State at the offices of the Highways Agency, The Cube, 199 Wharfside Street, Birmingham B1 1RN to arrive before 24<sup>th</sup> June 2011 and should state the title of the Order and quote reference 065/023/000130. It should give the grounds of objection and the objector's address and interests in the land. In the preparation of an objection and the statement of the grounds of objection, it should be borne in mind that



the substance of any objection or representation may be communicated to other people who may be affected by it

The contact for further information relating to this notice is Geoff Bethel of the Highways Agency who can be contacted on 0300 123 5000 or via e-mail at [A46newarkwidmerpool@highways.gsi.gov.uk](mailto:A46newarkwidmerpool@highways.gsi.gov.uk)

12th May 2011

Iftikhar Mir  
Highways Agency

#### DESCRIPTION OF LAND

##### IN THE PARISH OF FARNDON IN THE DISTRICT OF NEWARK AND SHERWOOD

Development/arable/pasture land, commercial access road, lorry park hard standing and drainage ditch, east of the existing A46(T), west of River Devon (owned by AT and PT Morris) (1/1, 1/1A, 1/1B, 1/1C, 1/1D, 1/1E, 1/1F, 1/1G, 1/1H)

Private driveway/adjacent ditch, arable/pasture land and drainage ditch east of the existing A46(T) west of River Devon (owned by CCS Lawrence) (1/2, 1/2A, 1/2B, 1/2C)

Development land/commercial access road, east of the A46(T), west of River Devon (owned by M Walmsley) (1/3, 1/3A)

Arable/pasture land, east of the existing (A46(T), west of River Devon (owned by P T Morris) (1/4, 1/4A)

Arable/pasture land and drainage ditch, east of the existing A46(T), west of River Devon (owned by PA Freight Services Ltd) (1/5)







the land which is described in the Schedules to this Order and is delineated and shown coloured pink on the plan.

- (2) Copies of this Order and of the Side Roads Order with their accompanying plans are deposited along with the plan referred to in article 4.
2. In relation to the purchase authorised by this Order, Parts II and III of Schedule 2 to the Acquisition of Land Act 1981 are incorporated with this Order subject to the modifications that references in those Parts to the undertaking shall be construed as references to the land authorised to be purchased and to any buildings or works constructed or to be constructed on it.
3. For the purpose of the provisions of Schedule 2 to the Acquisition of Land Act 1981, as incorporated in this Order, the prescribed distance in relation to any seam of minerals lying under land adjoining the works to be constructed upon the land described in the schedules to this Order shall be such a lateral distance from every side of those works as is equal at every point along those works to one half of the depth of the seam below the natural surface of the ground at that point or forty yards whichever is the greater.



4. In this Order:

“the plan” means the plan consisting of 1 sheet marked “The A46 Trunk Road (Newark to Widmerpool Improvement and Slip Roads) Supplementary Compulsory Purchase Order Number 1 20\_ \_”, signed by authority of the Secretary of State for Transport and deposited at Document Deposit Service, Communities and Local Government, Floor 13 (IMD), Ashdown House, St Leonards on Sea, Hastings, East Sussex TN37 7GA;

“the Trunk Road” means the A46 Trunk Road;

“the new trunk road” means the trunk road to be constructed in pursuance of the A46 Trunk Road (Newark to Widmerpool Improvement and Slip Roads) Order 2009;

“the Side Roads Order” means the A46 Trunk Road (Newark to Widmerpool Improvement and Slip Roads) Supplementary (Side Roads) Number 1 Order 20\_ \_

Note: The A46 Trunk Road (Newark to Widmerpool Improvement and Slip Roads) Order 2009, referenced in article 4 above, was previously made on 9 January 2009, coming into force on 30 January 2009.



This Order shall come into force on ..... 2... and may be cited as The A46 Trunk Road (Newark to Widmerpool Improvement and Slip Roads) Supplementary Compulsory Purchase Order Number 1 20\_\_

Signed by authority of the Secretary of State for Transport

.....

.....20...

Divisional Director  
Highways Agency



## **EXPLANATORY NOTE**

*(This note is not part of the Order)*

This Supplementary Compulsory Purchase Order authorises the compulsory purchase of land for the purpose of the construction of a new trunk road in pursuance of The A46 Trunk Road (Newark to Widmerpool Improvement and Slip Roads) Order 2009 (“the Trunk Road Order”), the provision of a new means of access to premises in pursuance of The A46 Trunk Road (Newark to Widmerpool Improvement and Slip Roads) Supplementary (Side Roads) Order Number 1 20\_\_ the improvement of the A46, the diversion of watercourses and the execution of other works on watercourses in connection with the construction of the Trunk Road and other connected purposes (Article 1).

The land is described in the Schedules to this Order and is delineated and shown coloured pink on the plan.



THE A46 TRUNK ROAD  
(NEWARK TO WIDMERPOOL IMPROVEMENT  
AND SLIP ROADS)  
COMPULSORY PURCHASE ORDER NUMBER 1  
20\_\_

	<p>Signed by authority of the Secretary of State for Transport.</p> <p>On the 20__</p> <p>A Divisional Director in the Highways Agency</p>
--	--



**SUPPLEMENTARY CPO No. 1 SCHEDULE 1 - Table 1  
A46 NEWARK TO WIDMERPOOL IMPROVEMENT**

Number on Map  (1)	Extent, description and situation of the land  (2)	Qualifying persons under paragraph 3 of Schedule 1 to the Acquisition of Land Act 1981 (3)			
		Owners or reputed owners	Lessees or reputed lessees	Tenants or reputed tenants (other than lessees)	Occupiers
Notes: 1. The area of each plot to be acquired is indicated in this Schedule in square metres. For conversion to the Imperial system of measurement: a. 1 square metre is equivalent to 1.196 square yards. b. 1 millimetre is equivalent to 0.039 inches.					
<b>In the Parish of Farndon in the District of Newark and Sherwood</b>					
1/1	27 square metres development/pasture land and commercial access road, east of the existing A46(T), west of River Devon	AT & PT Morris C/O P A Freight International, Logistics Centre Fosse Way Farndon Newark, Notts NG24 4SP	-	-	Owners
1/1A	541 square metres arable/pasture land and lorry park hard standing, east of the existing A46(T), west of River Devon	Ditto	-	-	Ditto
1/1B	20 square metres arable/pasture land, east of the existing A46(T), west of River Devon	Ditto	-	-	Ditto
1/1C	400 square metres arable/pasture land, east of the existing A46(T), west of River Devon	Ditto	-	-	Ditto
1/1D	135 square metres arable/pasture land, east of the existing A46(T), west of River Devon	Ditto	-	-	Ditto
1/1E	458 square metres arable/pasture land, east of the existing A46(T), west of River Devon	Ditto	-	-	Ditto
1/1F	733 square metres arable/pasture land and lorry park hard standing, east of the existing A46(T), west of River Devon	Ditto	-	-	Ditto

**SUPPLEMENTARY CPO No. 1 SCHEDULE 1 - Table 1  
A46 NEWARK TO WIDMERPOOL IMPROVEMENT**

Number on Map (1)	Extent, description and situation of the land (2)	Qualifying persons under paragraph 3 of Schedule 1 to the Acquisition of Land Act 1981 (3)			
		Owners or reputed owners	Lessees or reputed lessees	Tenants or reputed tenants (other than lessees)	Occupiers
1/1G	674 square metres arable/pasture land and drainage ditch, east of the existing A46(T), west of River Devon	Ditto	-	-	Ditto
1/1H	1001 square metres arable/pasture land and lorry park hard standing, east of the existing A46(T),	Ditto	-	-	Ditto
1/2	84 square metres private driveway/adjacent ditch, east of the existing A46(T), west of River Devon	CCS Lawrence Cranleigh Park 153a Farndon Road Newark. Notts NG24 4SP	-	-	Owner
1/2A	41 square metres private driveway/adjacent ditch, east of the existing A46(T), west of River Devon	Ditto	-	-	Ditto
1/2B	160 square metres arable/pasture land and drainage ditch, east of the existing A46(T), west of River Devon	Ditto	-	-	Ditto
1/2C	142 square metres arable/pasture land and drainage ditch, east of the existing A46(T), west of River Devon	Ditto	-	-	Ditto
1/3	338 square metres development land/commercial access road, east of the existing A46(T), west of River Devon	Mr M Walmsley Kardeel House 7 Bullpit Lane Balderton Newark NG24 3PT	-	-	Owner
1/3A	292 square metres development land/commercial access road, east of the existing A46(T), west of River Devon	Ditto	-	-	Ditto

**SUPPLEMENTARY CPO No. 1 SCHEDULE 1 - Table 1  
A46 NEWARK TO WIDMERPOOL IMPROVEMENT**

Number on Map (1)	Extent, description and situation of the land (2)	Qualifying persons under paragraph 3 of Schedule 1 to the Acquisition of Land Act 1981 (3)			
		Owners or reputed owners	Lessees or reputed lessees	Tenants or reputed tenants (other than lessees)	Occupiers
1/4	5 square metres arable/pasture land, east of the existing A46(T), west of River Devon	P T Morris C/O P A Freight International, Logistics Centre Fosse Way Farndon Newark, Notts NG24 4SP	-	-	Owner
1/4A	15 square metres arable/pasture land, east of the existing A46(T), west of River Devon	Ditto	-	-	Ditto
1/5	566 square metres arable/pasture land and drainage ditch, east of the existing A46(T), west of River Devon	P A Freight Services Ltd	-	-	Owner



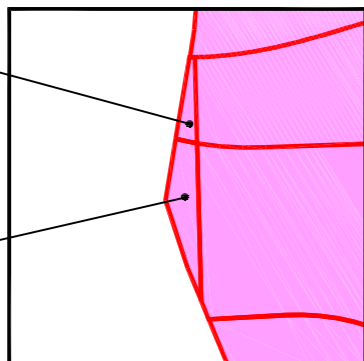
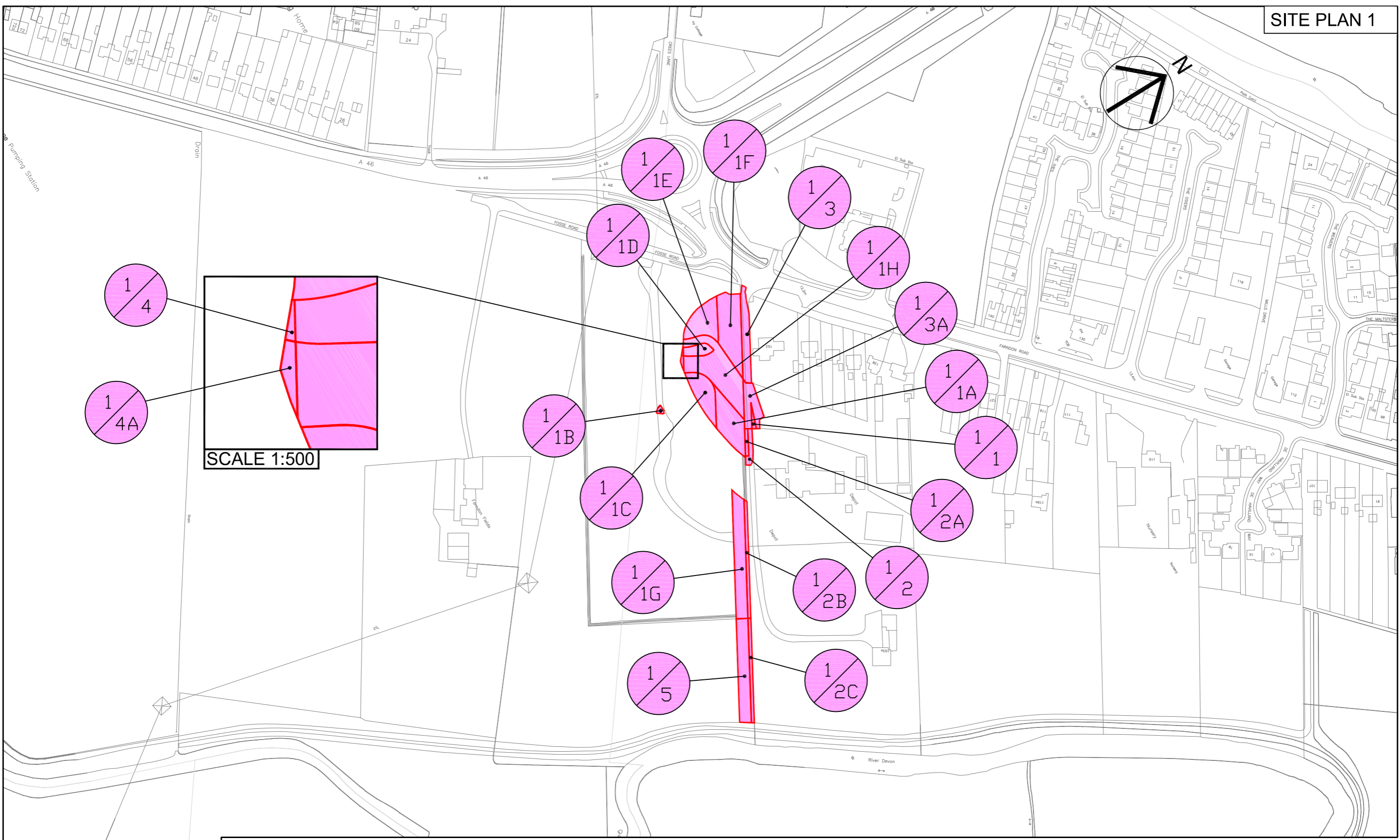

SCALE 1:500

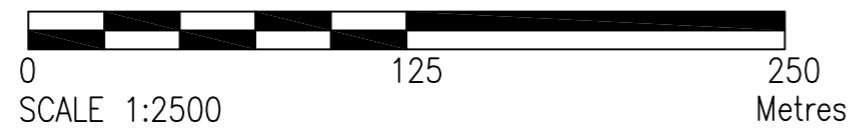

SCALE 1:2500

This map is reproduced from Ordnance Survey material with the permission of Ordnance Survey on behalf of the Controller of Her Majesty's Stationery Office © Crown copyright. Unauthorised reproduction infringes Crown copyright and may lead to prosecution or civil proceedings. Highways Agency 10018928/2011.

THE A46 TRUNK ROAD  
(NEWARK TO WIDMERPOOL IMPROVEMENT  
AND SLIP ROADS)  
SUPPLEMENTARY COMPULSORY PURCHASE  
ORDER NUMBER 1 (MP No. ) 20\_ \_